

PLAN SCALE 1:50

MULTI-PURPOSE HALL KEY PLAN

NO.	DATE	REVISION	DRAWN
A	2021-03-01	ISSUED FOR INFORMATION	DW RJS
B	2022-07-08 2022-04-13	ISSUED FOR MEASURE ISSUED FOR INFORMATION (EPMS) 1. DWG NO. CHANGED FROM 1617 TO 2204	DW

ISSUED FOR
APPROVAL

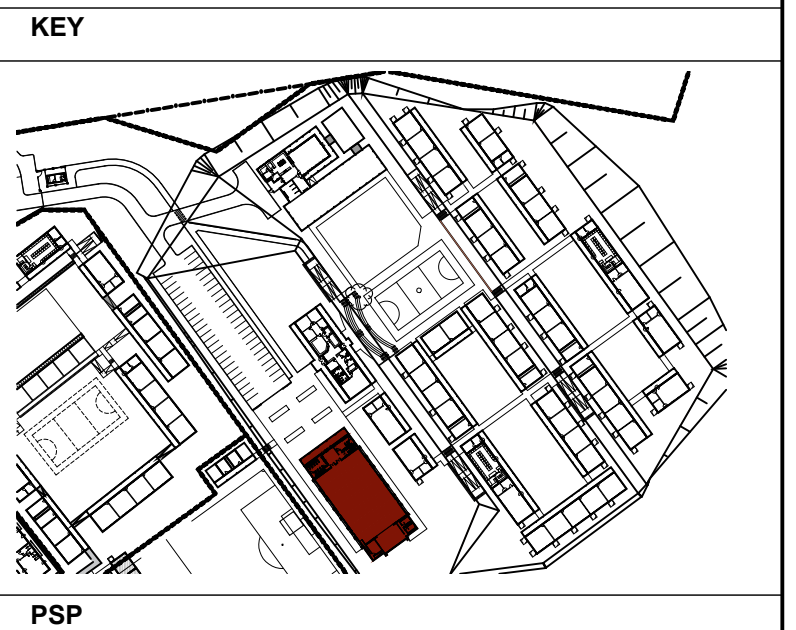

PSP

ARCHITECT





13 Cumberland Street, Mithatha
P.O. Box 7105
Mithatha, 5100
Tel: 047 532 5382
Fax: 086-648-2131

18 Lower Goldenhays Drive,
Emmarentia, Johannesburg
P.O. Box 61824
Auckland Park, 2006
Tel: 011-486-2623
Fax: 086-648-1935
Email: mpande@architect.co.za

ARCHITECTURAL PROFESSIONAL SACAP NUMBERS:
H.L. MANTEL SACAP 3045

IMPLEMENTED BY
**INDEPENDENT
DEVELOPMENT
TRUST**

SIGNATURE	DATE	SHEET NO.
DESIGNED		A1
DRAWN		SCALE 1:100
VERIFIED		STATUS LEGEND
VALIDATED		I = INFORMATION FA = FOR APPROVAL T = TENDER C = CONSTRUCTION AB = AS BUILT

CLIENT	IMPLEMENTING AGENT
	

PROJECT
**DOE PORTFOLIO PROGRAMME
ESTABLISHMENT OF NEW SCHOOLS
HILLBROW - SENIOR SECONDARY SCHOOL**
PROVINCE: EASTERN CAPE PROVINCE
DRAWING TITLE
**MULTI-PURPOSE HALL (BLOCK S-Y)
JOINERY PART 1 OF 3
KEY PLAN**

DRAWING DESCRIPTION
--

EMIS NUMBER	DISCIPLINE	DRAWING NUMBER	STATUS	REVISION
200500293	ARCH	2204 w07-07/700	FA	B